

Pre-delivery Inspection

PRE-DELIVERY INSPECTION

1. Pre-delivery Inspection

A: GENERAL DESCRIPTION

The purposes of the pre-delivery inspection (PDI) are as follows.

- Remove the vehicle protective parts for transportation.
- Check that the vehicle or parts before delivery are not damaged during transportation or storage.
- Check that the vehicle after repair is normal.
- Make sure to provide a complete vehicle to customer.

For above reasons, all SUBARU dealer must carry out the PDIs before delivery of vehicle.

Besides, all SUBARU dealer and PDI center check the condition of all vehicles to make sure to take responsibility.

B: PRE-DELIVERY INSPECTION (PDI) PROCEDURE

Static checks just after vehicle receipt

Item	Check point
1. Appearance	1. If the vehicle is covered with protective coating, visually check the vehicle body for damage and dents. If the protective coating has been removed, visually check the painted body surfaces in detail for damage or rust. 2. Visually check the glass and light lenses for any damage, cracks or excessive gaps between body panels. 3. Visually check the plated parts for any damage. 4. Check the instrument panel, console and trim for stains or dirt.
2. Tire	1. Check the tires for damage, defective, and dents on wheels. 2. Check the tire air pressure.
3. Fuses	If the vehicle is about to be delivered to customer, attach a back-up fuse.
4. Lock/unlock and open/close operation checks of doors	1. Using the key, check the door can be locked or unlocked normally. 2. Open and close all doors to check that there are no defective. 3. Operate the power door lock switch to check that all doors lock and unlock normally.
5. Child safety lock	Check the child safety lock system operates normally.
6. Trunk lid open/close operations	1. Operate the trunk opener button to check that the trunk lid opens normally. 2. Open and close the trunk lid to see that there are no abnormal conditions.
7. Trunk lid release lever	Operate the trunk lid release lever to check that the trunk lock is unlocked normally.
8. Fuel lid opener lever	Operate the fuel lid opener to check that the fuel lid is unlocked normally.
9. Towing hook (eyebolt)	At factory shipment, the towing hook (eyebolt) is installed to the rear bumper. Remove the towing hook (eyebolt), store it in the holder.
10. Accessory	Check that the following accessories are provided. <ul style="list-style-type: none">• Owner's manual• Warranty booklet• Maintenance note• Spare key• Key number plate• Jack• Tool set• Spare tire• Towing hook (eyebolt)
11. Front hood lock release system	Operate the front hood lock release lever to check that the front hood opens normally.
12. Battery	Check the battery for any abnormal conditions such as rust or traces of battery fluid leaks.
13. Brake fluid	Check the brake fluid amount.
14. Engine oil	Check the engine oil amount.
15. Transmission gear oil	<ul style="list-style-type: none">• Check that the transmission gear oil level is normal. (Except for STI model)• Check for leakage of the transmission gear oil. (STI model)
16. CVT front differential gear oil	Check for no leakage of CVT front differential gear oil.
17. Rear differential gear oil	Check for leakage of gear oil from the rear differential.
18. Engine coolant	Check the engine coolant level.
19. Clutch fluid	Check the clutch fluid amount.

Pre-delivery Inspection

PRE-DELIVERY INSPECTION

Item	Check point
20. Window washer fluid	Check the window washer fluid amount.
21. Front hood latch	Check that the front hood is closed normally and locked securely.
22. Keyless entry system	Check that the keyless entry system operates normally.
23. Keyless access system	Check that the keyless access function operates normally.
24. Alarm system	Check that the alarm system operates normally.
25. Seat	1. Check the seat surfaces for stains or dirt. 2. Check the seat installation conditions and functionality.
26. Seat belt	1. Check the seat belt installation conditions and functionality. 2. Check the seat belt warning system operates normally.
27. TPMS (U.S. model)	If the display of TPMS warning light does not operate normally, perform the diagnosis by referring to TPMS (Diagnosis).

Checks with the engine running

Item	Check point
28. Grommet installation	Install the grommet provided in the glove box to the tie-down hole.
29. Delivery (test) mode	Turn the ignition switch to ON and check that the malfunction indicator light starts blinking.
30. Immobilizer system	1. Check that the engine starts with all keys that are equipped on vehicle. 2. Check that the security indicator light operates normally.
31. Push button start	Using the push button start function of the access key equipped with the vehicle, check that the engine starts and stops.
32. Starting condition	Start the engine and check that the engine starts smoothly.
33. Exhaust system	Check that the exhaust noise is normal and no leaks are found.
34. Indicator and warning lights	Check that all indicator lights and warning lights are operating correctly.
35. Heater & ventilation	Check that the heater & ventilation system operates normally.
36. Air conditioner	Check that the air conditioner operates normally.
37. Multi-function display (MFD)	1. Check that the Multi-Function Display (MFD) function operates normally. 2. Check that the rearview camera operates normally.
38. Audio	Check that all audio functions operate normally.
39. Navigation system	1. Check all display functions for normal operation. 2. Check that the navigation, audio and AUX systems operate normally. 3. Check that the rearview camera operates normally.
40. Accessory power supply socket	Check that the accessory power supply socket operates normally.
41. Lighting system	Check that the lighting system operates normally.
42. Wiper deicer	Check that the wiper deicer operates normally.
43. Illumination control	Check that the illumination control operates normally.
44. Window washer	Check that the window washer operates normally.
45. Wiper	Check that the wiper operates normally.
46. Power window	Check that the power window operates normally.
47. Sunroof	Check that the sunroof operates normally.
48. Rear defogger	Check that the rear defogger operates normally.
49. Door mirror	Check that the mirror heater and remote control mirror operate normally.
50. Parking brake	Check the parking brake for normal operations.
51. Diagnostic trouble code (DTC) check	Check that the diagnostic trouble code (DTC) is not detected.

Dynamic test with the vehicle running

Item	Check point
52. Brake test	Check the foot brake for normal operations.
53. Shift control	Check that the MT, CVT shifts normally.
54. Cruise control	Check that the cruise control system operates normally.

Pre-delivery Inspection

PRE-DELIVERY INSPECTION

Checks after dynamic test

Item	Check point
55. Power steering system (hydraulic power steering model)	Check that the power steering fluid level is normal.
56. Power steering system (electric power steering model)	Check the steering warning light operation.
57. Fluid leakage	Check for fluid/oil leaks.
58. Water leakage	Spray the vehicle with water and check for water leaks.
59. Appearance 2	1. Remove the protective coat. (If attached) 2. Check the body paints for damage and stain. 3. Check the plated parts for damage and rust.

1. APPEARANCE

- If the vehicle is covered with protective coating, visually check the vehicle body for damage and dents.
- If the protective coating has been removed, visually check the body painted area for damage or stains in detail and repair as necessary.
- Visually check the windshield glass, door glasses and light lenses for any damage, cracks or excessive gaps to the body panel and repair as necessary.
- Visually check the plated parts, such as the grilles and door knobs, for damage or loss of gloss and replace the parts as necessary.
- Check the instrument panel, console and trim for stains or dirt.

2. TIRE

- Check the tires for damage, defective, and dents on wheels.
- Check and correct the tire size, spare tire and tire air pressure described on the tire air pressure label (driver's side).

3. FUSE

Fuses for the back-up circuit on initially delivered vehicles are removed to prevent battery discharge. Attach the 20 A fuse as shown in the figure.

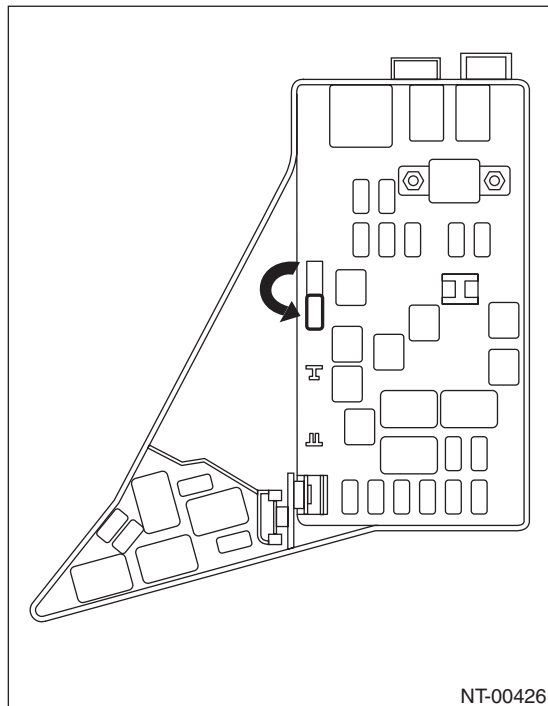

4. LOCK/UNLOCK AND OPEN/CLOSE OPERATION CHECKS OF DOORS

1) Using the key, lock and unlock the door several times to check for normal operation. Open and close the door several times for smooth movement.

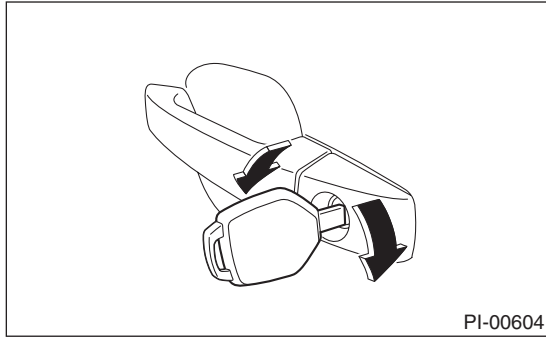

PI-00604

2) Completely close the driver's door, and then check the smooth movement with operating door lock knob from lock to unlock several times. Set the door lock knob (A) to lock position. Then pull the inner remote (B) to ensure that doors will not open.

For other doors, place the door lock knob (A) to lock position and then pull the inner remote (B) to ensure that doors will not open.

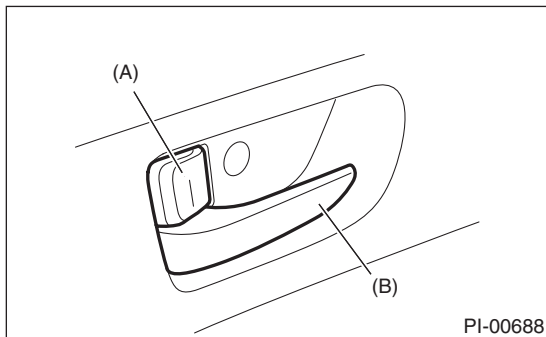

PI-00688

(A) Door lock knob

(B) Inner remote

3) Close all the doors, and then press the lock on power door lock switch at driver's side. Check that all doors lock.

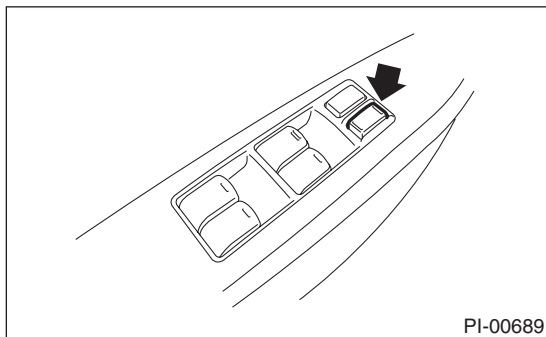

PI-00689

Pre-delivery Inspection

PRE-DELIVERY INSPECTION

- 4) Press the driver's side power door lock switch to unlock side. Check that all doors are unlocked.

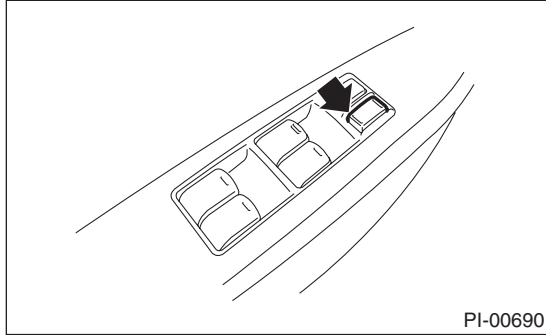

- 5) Check that the passenger's power door lock switch locks and unlocks normally in the same manner.

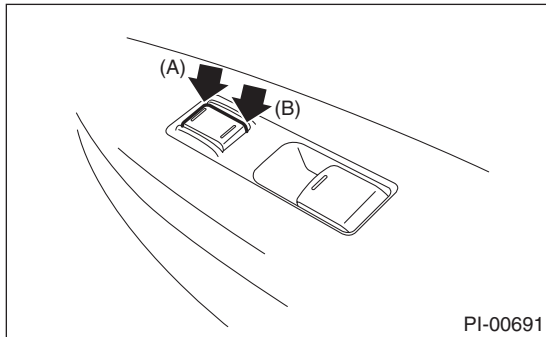

- (A) Lock
(B) Unlock

- 6) With ACC ON or IGN ON, open the driver's door. Press lock on power door lock. Check that the door is not locked.

5. CHILD SAFETY LOCK SYSTEM

- 1) Set the child safety lock on both rear doors to the lock position.
- 2) Close the rear doors completely.
- 3) Check that the lock levers of the rear doors are in the unlock position. Then, pull inner remote of rear doors to ensure that the doors will not open.

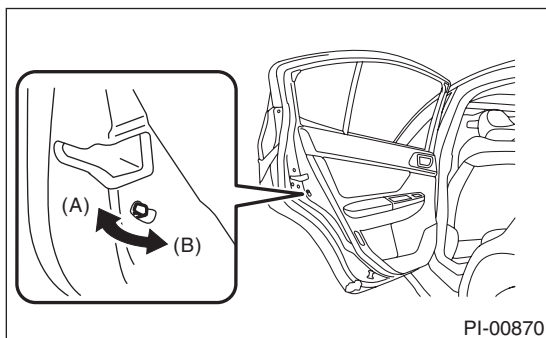

- (A) Unlock
(B) Lock

- 4) Pull the outer handles of rear doors to ensure that the doors will open.

6. TRUNK LID OPEN/CLOSE OPERATIONS

- 1) Operate the trunk opener button to check that the trunk lid opens.
- 2) Open and close the trunk lid several times for smooth movement.

7. TRUNK LID RELEASE LEVER OPERATIONS

CAUTION:

Do not check the trunk lid release lever when in the trunk. If the trunk lid release lever is defective, you may be trapped in.

1) Use a flat tip screwdriver. Slide the screwdriver blade from the slit aperture of the lock assembly fully to the end until you hear a click. This places the latch in the locked position.

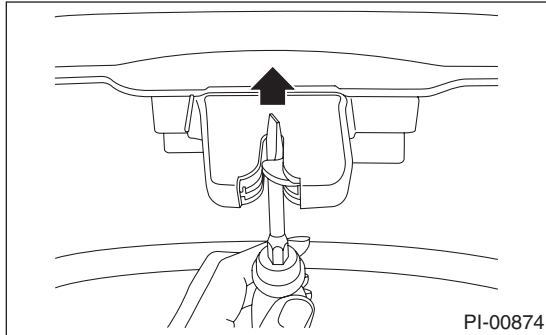

2) Make sure the latch is released by pulling the yellow trunk lid release lever in the direction of arrow.

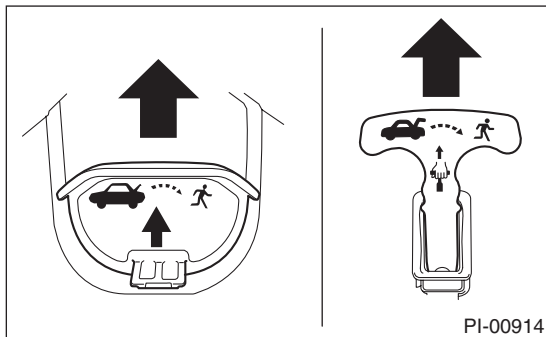

8. FUEL LID OPENER LEVER

Operate the fuel lid opener to check that the fuel filler lid can be unlocked normally. Check that the filler cap is securely closed.

9. TOWING HOOK (EYEBOLT)

NOTE:

At factory shipment, the towing hook (eyebolt) is installed to the rear bumper for securing the vehicle during transportation. Follow the procedure below to store the towing hook (eyebolt) to the holder in the spare tire.

1) Remove the towing hook (eyebolt) from the rear bumper.

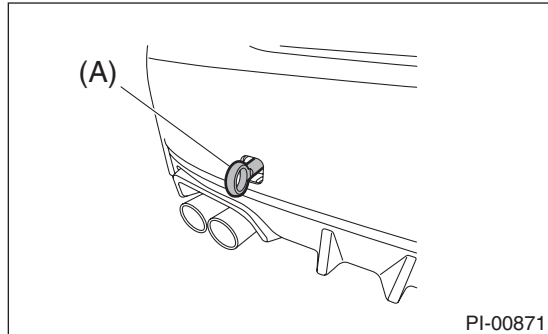

(A) Towing hook (eyebolt)

2) Store the towing hook (eyebolt) to the holder in the spare tire.

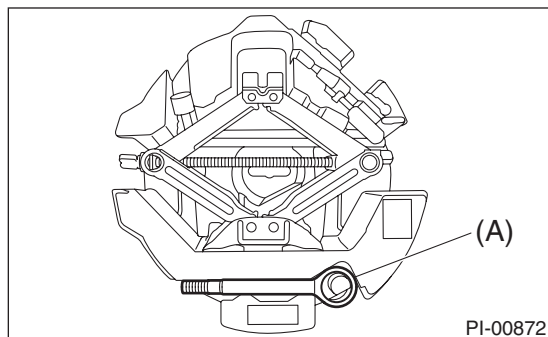

(A) Towing hook (eyebolt)

3) Install the supplied rear hook cover to rear bumper.

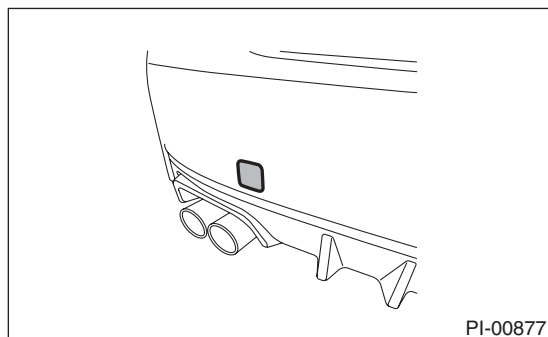

10.ACCESSORY

Check that the following accessories are provided.

- Owner's manual
- Warranty booklet
- Maintenance note
- Spare key
- Key number plate
- Jack
- Tool set
- Spare tire
- Towing hook (eyebolt)

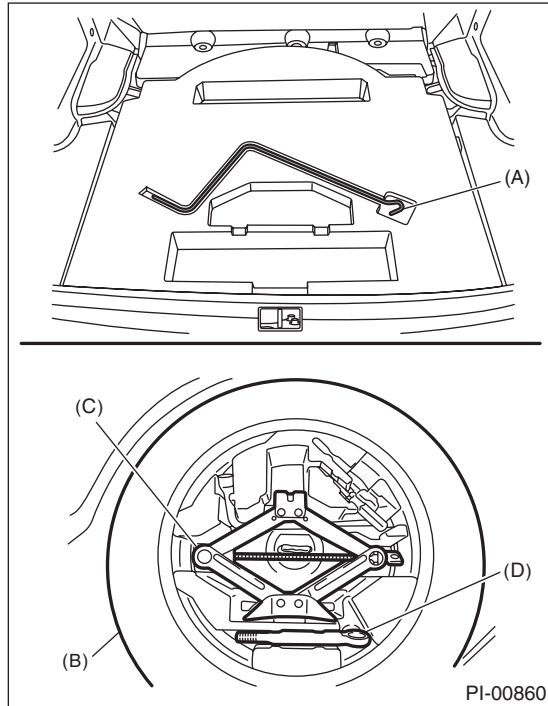

- (A) Jack handle
- (B) Spare tire
- (C) Jack
- (D) Towing hook (eyebolt)

Pre-delivery Inspection

PRE-DELIVERY INSPECTION

11.FRONT HOOD LOCK RELEASE SYSTEM

Operate the front hood lock release lever to check that the front hood is unlocked normally.



Operate the lever (A) and check that the front hood is opened normally. Check that the front hood can be supported by damper stay.

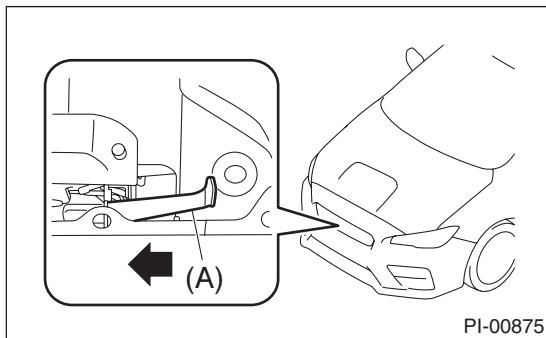

12.BATTERY

Check the battery terminals to make sure that there are no rust or corrosion due to fluid leaks. Check that the battery caps are securely tightened.

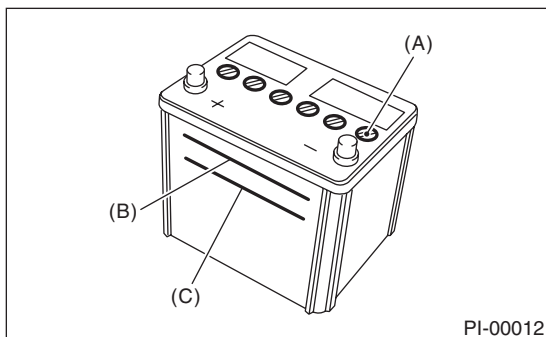

- (A) Cap
- (B) Upper level
- (C) Lower level

13.BRAKE FLUID

CAUTION:

- If the brake fluid is spilt over exhaust pipe, wipe it off with cloth to avoid emitting smoke or causing a fire.
- Always check the level using the specified direction because there is a partition in the reservoir tank.

Check that the brake fluid level is normal from a straight view or within 90° to the right and left forward. If the amount is insufficient, carry out a brake line test to identify brake fluid leaks and check the brake operation. After that, refill the brake fluid tank with the specified type of fluid.

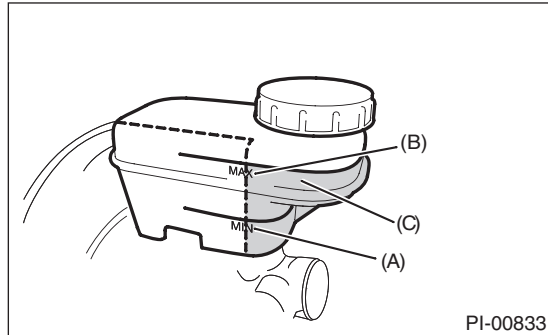

- (A) MIN. level
- (B) MAX. level
- (C) Brake fluid

14.ENGINE OIL

CAUTION:

If the engine oil is spilt over exhaust pipe or the under cover, wipe it off with cloth to avoid emission of smoke or causing a fire.

- 1) Park the vehicle on a level surface.
- 2) Remove the oil level gauge and wipe away the oil.
- 3) Reinsert the oil level gauge all the way. Be sure that the oil level gauge is correctly inserted and properly orientated.
- 4) Pull out the oil level gauge again, and check both sides of the oil level gauge. Use a lower side to determine the engine oil level. If the engine oil level is below "L" line, add oil to bring the level up to "F" line.
- 5) Start the engine, and spread the oil in engine room.

Pre-delivery Inspection

PRE-DELIVERY INSPECTION

6) After turning off the engine, wait a few minutes for the oil to return to the oil pan before checking the oil level.

NOTE:

To prevent overfilling of engine oil, do not add oil above “F” line when the engine is cold.

- Except for STI model

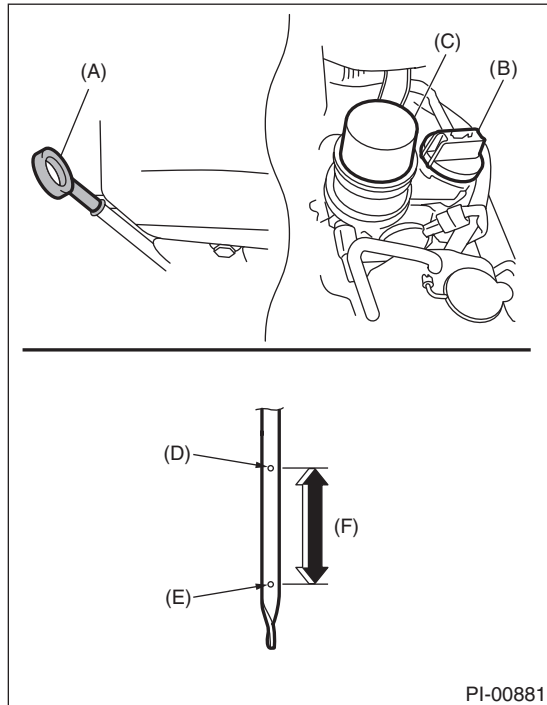

- (A) Engine oil level gauge
- (B) Engine oil filler cap
- (C) Engine oil filter
- (D) “F” line
- (E) “L” line
- (F) Approx. 1.0 L (1.1 US qt, 0.9 Imp qt)

- STI model

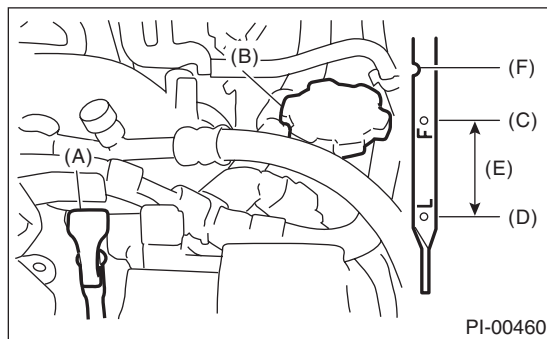

- (A) Engine oil level gauge
- (B) Engine oil filler cap
- (C) “F” line
- (D) “L” line
- (E) Approx. 1.0 L (1.1 US qt, 0.9 Imp qt)
- (F) Notch mark

15.TRANSMISSION GEAR OIL

CAUTION:

If transmission gear oil is spilt over the exhaust pipe, wipe it off with a cloth to avoid emitting smoke or causing a fire.

Except for STI model

Check that the transmission gear oil level is normal. If the amount of gear oil is insufficient, check that no leaks are found. Then add the necessary amount of the specified transmission gear oil.

Refer to “6MT” section for transmission gear oil inspection. <Ref. to 6MT(TY75)-23, INSPECTION, Transmission Gear Oil.>

STI model

Check for leakage of the transmission gear oil.

16.CVT FRONT DIFFERENTIAL GEAR OIL

CAUTION:

If gear oil is spilt over the exhaust pipe, wipe it off with a cloth to avoid emitting smoke or causing a fire.

Check for no leakage of CVT front differential gear oil.

17.REAR DIFFERENTIAL GEAR OIL

CAUTION:

If the rear differential gear oil is spilt over exhaust pipe, wipe it off with cloth to avoid emitting smoke or causing a fire.

Check for leakage of gear oil from the rear differential.

18.ENGINE COOLANT

CAUTION:

If the engine coolant is spilt over exhaust pipe, wipe it off with cloth to avoid emitting smoke or causing a fire.

Check that the engine coolant level on the reservoir tank is normal. If the amount of engine coolant is insufficient, check that no leaks are found. Then, add the necessary amount of coolant with the specified concentration.

19. CLUTCH FLUID

CAUTION:

- If any clutch fluid is spilt on the exhaust pipe, wipe it off with a cloth to avoid emitting smoke or causing a fire.
- This reservoir tank has the brake fluid chamber and the clutch fluid chamber. When checking the fluid level, always check the fluid from the clutch fluid chamber side where the tank hose is connected.

Check that the clutch fluid level is normal. If the amount of fluid is insufficient, check that no leaks are found. Then, add the necessary amount of specified fluid.

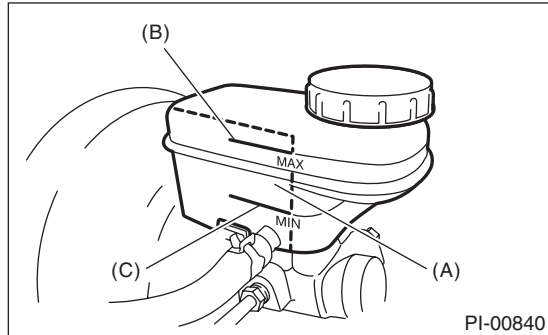

- (A) Clutch fluid chamber
- (B) MAX. level
- (C) MIN. level

20. WINDOW WASHER FLUID

Check that the window washer fluid level is normal. If the amount of washer fluid is insufficient, check that no leaks are found. Then, add the necessary amount of washer fluid.

NOTE:

If there is the vibration, water comes into the layer of air in the washer tank and the water level may drop. This is not a malfunction.

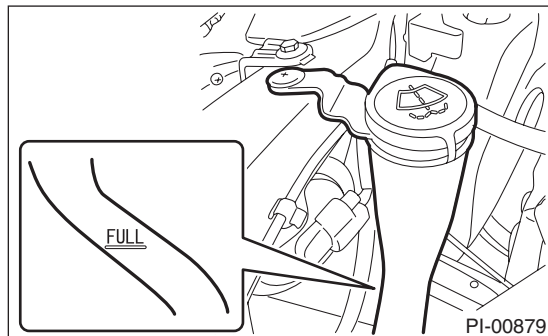

21. FRONT HOOD LATCH

Close the front hood. Check that the front hood is securely latched.

22.KEYLESS ENTRY SYSTEM

Check the keyless entry system operations as follows:

- Fully open all the door windows.
- Remove the key from ignition switch, and then close all doors.
- Press the “LOCK/ARM” button momentarily. Check that all the doors become locked, the buzzer sounds once, and the hazard lights flash once.

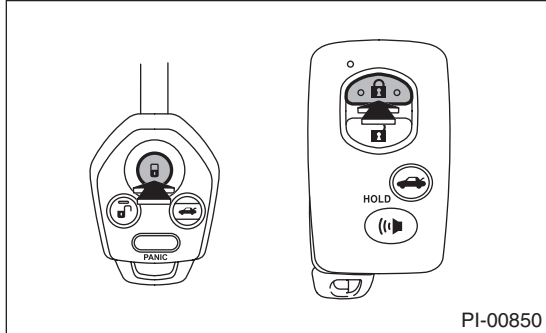

- Press the “UNLOCK/DISARM” button momentarily. Check that the driver’s door is unlocked, the buzzer sounds twice, and the hazard lights flash twice.

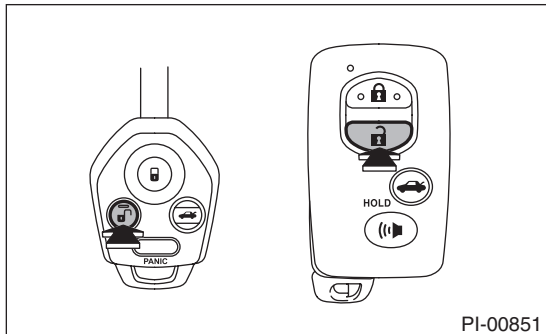

- Within 5 seconds, press the “UNLOCK/DISARM” button momentarily. Check that all doors are unlocked, the buzzer sounds twice, and the hazard lights flash twice.
- Check that the buzzer sounds twice, and the hazard lights flash twice, when the trunk lid unlock button is held down to unlock the trunk lid.

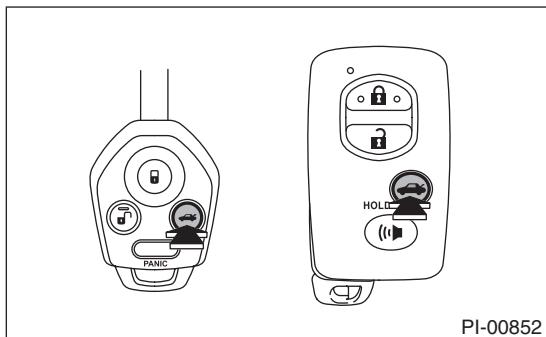

Pre-delivery Inspection

PRE-DELIVERY INSPECTION

- Press the “PANIC” button. Check that the panic mode (the horn keeps sounding) is initiated. Also, check that this condition continues for 30 seconds or until when any of the buttons on the key are pressed.

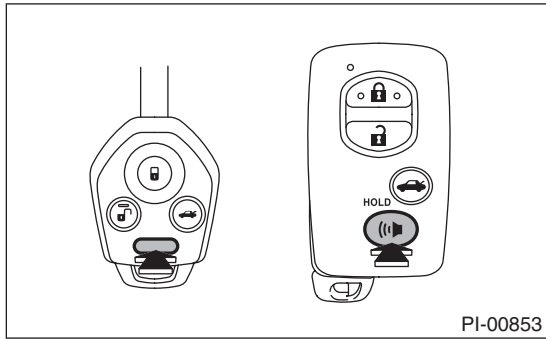

- Press the “LOCK/ARM” button momentarily with one of the doors opened. Check that the buzzer sounds 5 times, and the hazard light flashes 5 times to notify the door not being fully closed. Then, close all doors. Check if all doors are locked and buzzer sounds once and the hazard light flashes once.
- With one of the doors open, press the “LOCK” side of the power door lock switch. Then, close all doors. Check if all doors are locked and buzzer sounds once and the hazard light flashes once.

- Driver's side

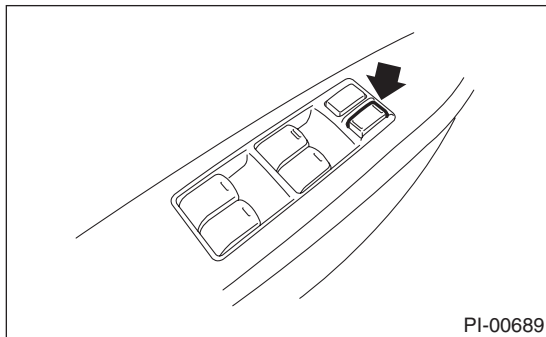

- Passenger's side

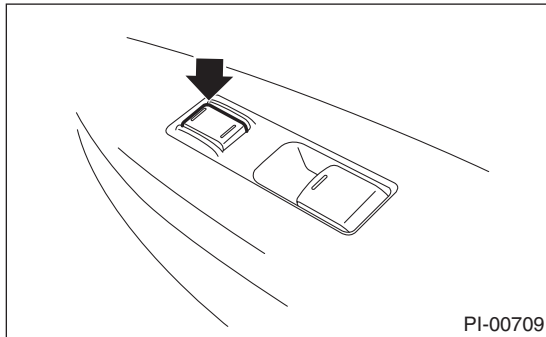

Check keyless answer-back buzzer operation

- The system uses the buzzer and sounds the keyless answer-back buzzer when the door is locked or unlocked. The keyless answer-back buzzer can be turned OFF. To turn the keyless answer-back buzzer from ON to OFF, close all doors, (with the key not inserted into the key cylinder), hold down the “UNLOCK” side of the power door lock switch and insert the key into the key cylinder. Within 10 seconds, insert and take out the key for 5 times or more, and within 10 seconds after that, open and close the driver's door. With the door closed, the hazard light will flash 3 times, indicating that the keyless answer-back buzzer has been turned OFF. To turn the keyless answer-back buzzer from OFF to ON, perform this procedure again. The hazard light will flash 3 times, indicating that the keyless answer-back buzzer has been turned ON.

23.KEYLESS ACCESS FUNCTION

CAUTION:

- When performing the check, check one access key at a time, separating individual keys.
- Do not leave any separated access keys in the vehicle.
- Fully open all the door windows.

NOTE:

The following inspections show the initial settings. When the settings are different from the initial settings, use Subaru Select Monitor to check the details of each setting for inspections. <Ref. to BC(diag)-15, OPERATION, Read Current Data.>

- While carrying the access key, check that the room light illuminates when you move close to the front door handles of the vehicle whose doors are all locked.
- While carrying the access key, check that the driver's door is unlocked, the buzzer sounds, and the hazard light blinks by grasping the front door knob (touching the touch sensor on the driver's side (unlock)).
- While carrying the access key, check that all doors are unlocked, the buzzer sounds, and the hazard light blinks by grasping the front door knob (touching the touch sensor on the passenger's side (unlock)).
- While carrying the access key, check that all doors are locked, the buzzer sounds, and the hazard light blinks by touching the touch sensor (lock) of the front door.

NOTE:

- The hazard lights flash twice and the buzzer sounds twice when unlocking.
- The hazard lights flash once and the buzzer sounds once when locking.

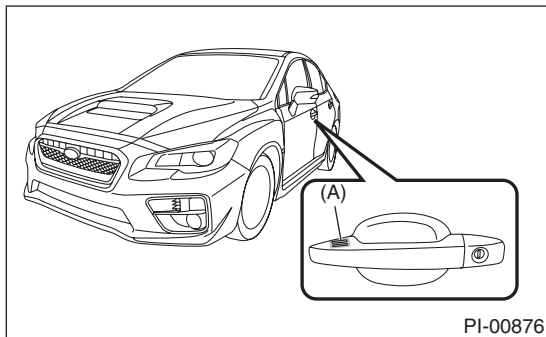

(A) Touch sensor (lock)

- Manually operate the access key button to check the lock/unlock of doors, flashing of hazard lights, and sounding of the buzzer.
- Check the mechanical key attached to the access key can be used for locking/unlocking.

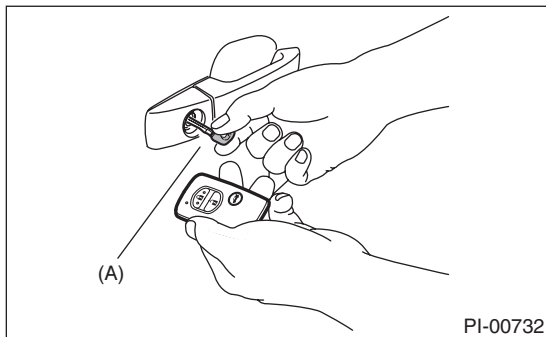

(A) Mechanical key

- With the access key in the vehicle, check that warning buzzer sounds and locking does not occur when you touch the touch sensor on the door (lock).

CAUTION:

Remove the mechanical key from the access key and hold the mechanical key.

24.ALARM SYSTEM

• Model without keyless access function

NOTE:

The following inspections show the initial settings. When the settings are different from the initial settings, use Subaru Select Monitor to check the details of each setting for inspections. <Ref. to BC(diag)-22, OPERATION, Registration Body Integrated Unit.>

- 1) Fully open all the door windows.
- 2) Remove the key from ignition switch, and then close all doors.
- 3) Press the “LOCK” button momentarily on the keyless transmitter. All doors are locked, and the security indicator light blinks faster for 30 seconds and blinks slowly twice repeatedly, then the alarm system is in set condition.

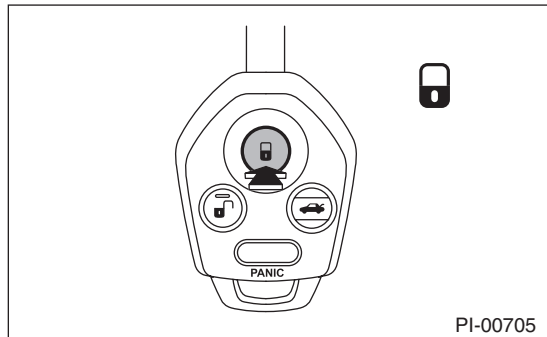

- 4) Press the “UNLOCK” button momentarily on the keyless transmitter. When the door of the driver’s seat is unlocked, the security indicator light blinks, and the alarm system enters the release mode.

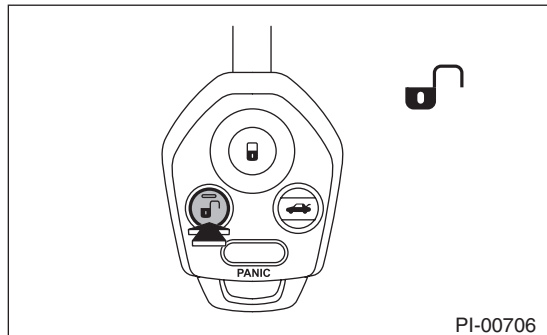

- 5) Press the “LOCK” button once on the keyless transmitter with one of the doors open. Check that the buzzer sounds 5 times to give the door not fully closed warning. All doors are locked when they are closed, and the security indicator light blinks faster for 30 seconds and blinks slowly twice repeatedly, then the alarm system is in set condition.
- 6) Press the “UNLOCK” button momentarily on the keyless transmitter. When the door of the driver’s seat is unlocked, the security indicator blinks, and the alarm system enters the release mode.

7) With one of the doors open, press the “LOCK” side of the power door lock switch. All doors are locked when they are closed, and the security indicator light blinks faster for 30 seconds and blinks slowly twice repeatedly, then the alarm system is in set condition.

- Driver’s side

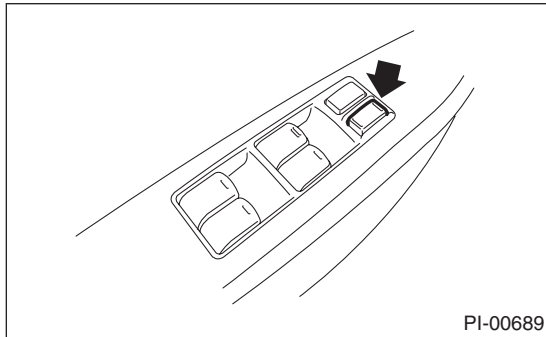

- Passenger’s side

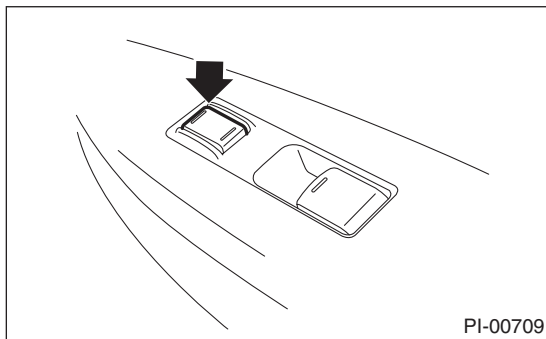

8) Unlock a door using the inner lock knob or the key and open the door while the security system is in the set mode. Check if the alarm condition occurs (horn sounds continuously, hazard light blinks, security indicator light illuminates). Check if this condition lasts until any button of the keyless transmitter is pressed or until the ignition switch is turned to IGN ON after inserting the key into the ignition switch.

NOTE:

The alarm sounds for three minutes with the door open.

9) On models equipped with an impact sensor, hit the windshield glass with your hand with the alarm system in the monitoring condition, to check that the alarm condition occurs.

10) Turn the ignition switch to ON and check that the security indicator light indicates the alarm history.

NOTE:

- When alarm history for the opening of door is present, the security indicator light illuminates for one second and then blinks 5 times.
- When alarm history for the opening of trunk is present, the security indicator light illuminates for one second and then blinks 4 times.
- When alarm history for the impact sensor is present, the security indicator light illuminates for one second and then blinks twice.
- When warning history for the impact sensor is present, the security indicator light illuminates for one second and then blinks once.
- When more than one histories are present, the alarm history with higher priority is indicated (higher priority from above).

11) Press the “LOCK” button on the keyless transmitter momentarily to arm the alarm system. Press the “UN-LOCK” button on the keyless transmitter momentarily to disarm the alarm system.

12) Turn the ignition switch to ON and check that the security indicator light does not indicate the alarm history. (The security indicator light remains OFF.)

13) When none of above is applicable, perform troubleshooting for the security system.

Pre-delivery Inspection

PRE-DELIVERY INSPECTION

• Model with keyless access function

NOTE:

The following inspections show the initial settings. When the settings are different from the initial settings, use Subaru Select Monitor to check the details of each setting for inspections. <Ref. to BC(diag)-22, OPERATION, Registration Body Integrated Unit.>

- 1) Fully open all the door windows.
- 2) Turn the ignition switch to OFF and close all doors.
- 3) Press the “LOCK” button momentarily on the access key. All doors are locked, and the security indicator light blinks faster for 30 seconds and blinks slowly twice repeatedly, then the alarm system is in set condition.

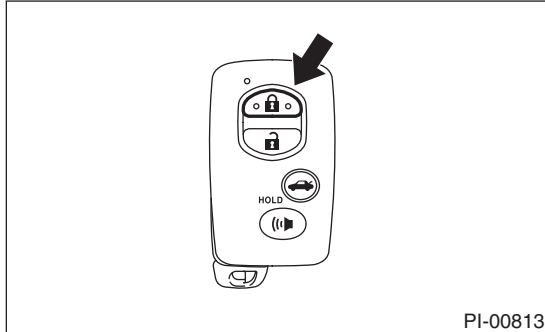

- 4) Press the “UNLOCK” button momentarily on the access key. When the door of the driver’s seat is unlocked, the security indicator light blinks, and the alarm system enters the release mode.

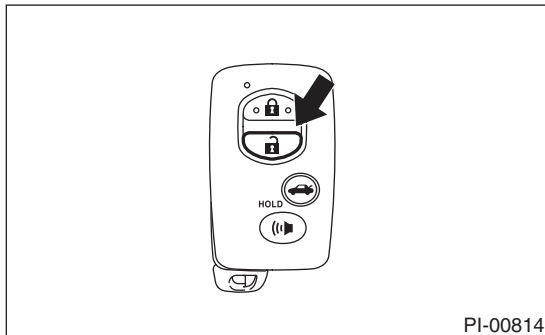

- 5) Press the “LOCK” button once on the access key with one of the doors open. Check that the buzzer sounds 5 times to give the door not fully closed warning. All doors are locked when they are closed, and the security indicator light blinks faster for 30 seconds and blinks slowly twice repeatedly, then the alarm system is in set condition.
- 6) Press the “UNLOCK” button momentarily on the access key. When the door of the driver’s seat is unlocked, the security indicator blinks, and the alarm system enters the release mode.
- 7) With one of the doors open, press the “LOCK” side of the power door lock switch. All doors are locked when they are closed, and the security indicator light blinks faster for 30 seconds and blinks slowly twice repeatedly, then the alarm system is in set condition.

• Driver’s side

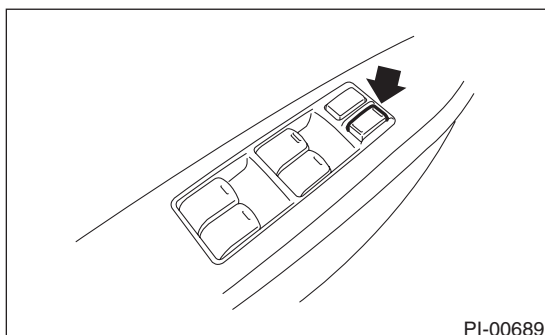

- Passenger's side

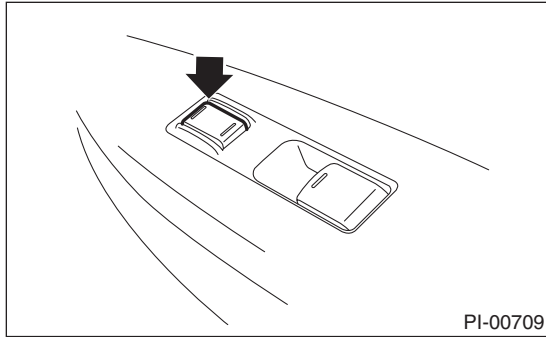

8) Unlock a door using the mechanical key and open the door while the security system is in the set mode. Check if the alarm condition occurs (horn sounds continuously, hazard light blinks, security indicator light illuminates). Check if this condition lasts until any button on the access key is pressed or until the ignition switch is turned to ACC.

NOTE:

The alarm sounds for three minutes with the door open.

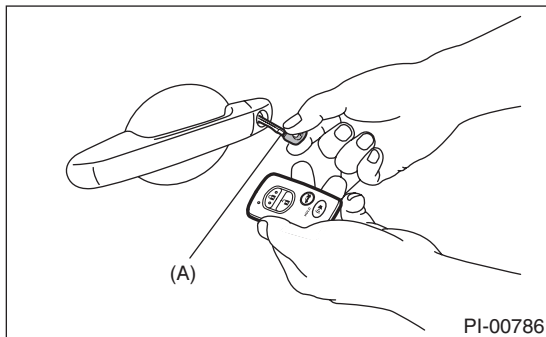

(A) Mechanical key

9) On models equipped with an impact sensor, hit the windshield glass with your hand with the alarm system in the monitoring condition, to check that the alarm condition occurs.

10) Turn the ignition switch to ON and check that the security indicator light indicates the alarm history.

NOTE:

- When alarm history for the opening of door is present, the security indicator light illuminates for one second and then blinks 5 times.
- When alarm history for the opening of trunk is present, the security indicator light illuminates for one second and then blinks 4 times.
- When alarm history for the impact sensor is present, the security indicator light illuminates for one second and then blinks twice.
- When warning history for the impact sensor is present, the security indicator light illuminates for one second and then blinks once.
- When more than one histories are present, the alarm history with higher priority is indicated (higher priority from above).

11) Press the "LOCK" button on the access key momentarily to arm the alarm system. Press the "UNLOCK" button on the access key momentarily to disarm the alarm system.

12) Turn the ignition switch to ON and check that the security indicator light does not indicate the alarm history. (The security indicator light remains OFF.)

13) When none of above is applicable, perform troubleshooting for the security system.

Pre-delivery Inspection

PRE-DELIVERY INSPECTION

25. SEAT

- 1) Check the seat surfaces for stains or dirt.
- 2) Check that each seat provides full functionality in sliding, reclining, lifter, and tilting. Check all available functions of the rear seat such as backrest tilt knob.
- 3) Check the passenger's seat occupant detection system.
 - (1) Empty the passenger's seat and turn the ignition switch to ON.
 - (2) Check that the passenger airbag ON/OFF indicator lights both turn on simultaneously for approximately six seconds, and after turning off for two seconds, only the OFF light illuminates.

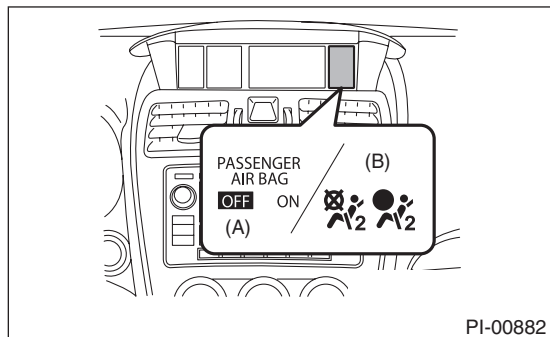

- (A) Airbag ON/OFF indicator light (U.S. (U5) model)
- (B) Airbag ON/OFF indicator light (Canada (C0), Mexico (C4) models)

- 4) With a person weighing approximately 70 kg (155 lb) or more sitting in the passenger's seat, check whether the ON light of the passenger's airbag ON/OFF indicator illuminates or not.
- 5) Have the passenger get out of the passenger's seat, and check whether the OFF light of the passenger side airbag ON/OFF indicator illuminates.

26. SEAT BELT

- 1) Check installation condition of seat belt.
- 2) Pull out the seat belt and then release it. Check that the belt retracts smoothly.
- 3) Check seat belt warning function.
 - (1) Turn the ignition switch to ON with the driver's and passenger's seat belt detached.
 - (2) Check the driver's and passenger's seat belt warning light blink for approx. 6 seconds and the buzzer sounds intermittently.
 - (3) Then, check the seat belt warning light illuminates and blinks repeatedly at a cycle of approx. 15 seconds. (If no passenger is on the passenger's seat, the seat belt warning light on passenger's seat does not operate.)

27. TPMS (U.S. MODEL)

- 1) Turn the ignition switch to ON, and check that the TPMS warning light is in a normal operation condition.
 - Normal operation (IG ON (light check))

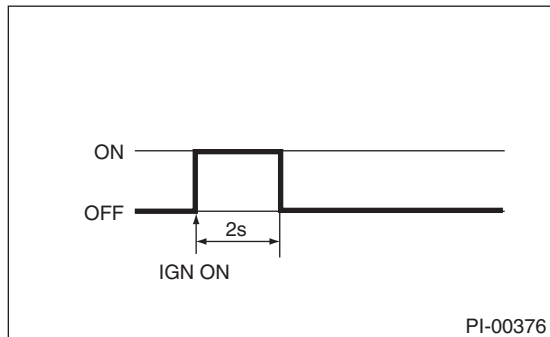

- 2) If the TPMS warning light display does not operate normally, check and repair the system. <Ref. to TPM(diag)-2, Basic Diagnostic Procedure.>

28.GROMMET INSTALLATION

Install the grommet provided in the glove box to the tie-down hole.

CAUTION:

Make sure that the tie-down hole is firmly plugged with the grommet. Otherwise, dust, smell, etc. may come into the passenger compartment indirectly from the rear quarter, via the side sill from the tie-down hole.

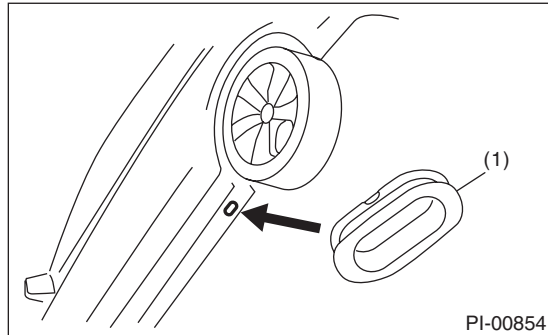

(1) Grommet

29.DELIVERY (TEST) MODE

- 1) Turn the ignition switch to ON and check that the malfunction indicator light starts blinking.
- 2) If the light blinks, return the ignition key to LOCK.
- 3) Remove the D check fuse and attach it to the spare fuse holder provided on the fuse box cover.

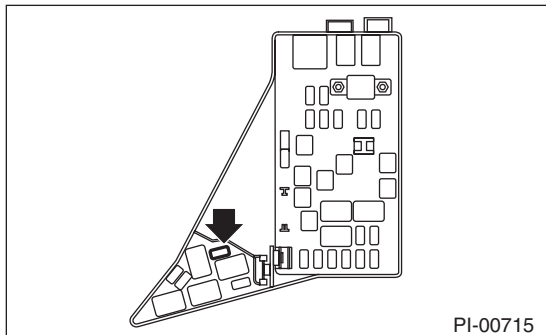

- 4) Then, turn the ignition key to ON again.
- 5) Make sure that the malfunction indicator light is off. If the malfunction indicator light blinks, carry out an engine diagnosis.

30.IMMOBILIZER SYSTEM

- 1) Check that the engine starts with all keys that are equipped on vehicle. Also, when starting the engine, check that the security indicator light goes off.
- 2) Check that the security indicator light blinks in 60 seconds after turning the ignition switch from ON to ACC or to OFF, or immediately after removing the key. Also, when starting the engine, check that the security indicator light goes off. (Model without keyless access function)
- 3) Immediately after turning ignition switch from ON to OFF, or with the key not in the vehicle and when opening/closing a door while the ignition switch is in ON or ACC with the engine stopped, check that the security indicator light is blinking. (Model with keyless access function)

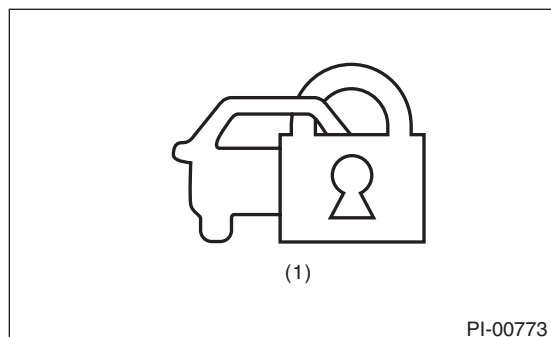

(1) Security indicator light

NOTE:

If malfunctions occur, refer to “IMMOBILIZER (DIAGNOSTICS)”. <Ref. to IM(diag)-2, Basic Diagnostic Procedure.>

31.PUSH BUTTON START FUNCTION

• CVT model

- 1) Get into the vehicle while carrying the access key, with the vehicle in P range and the brake pedal OFF, and check that every time the push button ignition switch is pressed, that it cycles through ACC → IGN ON → IGN OFF, and the indicator light for the push button ignition switch is illuminated in orange.
- 2) Get into the vehicle while carrying the access key, with the vehicle in P range and the brake pedal ON, check that the indicator light for the push button ignition switch is illuminated in green.

NOTE:

While the select lever button is being pressed, the indicator light of the push button ignition switch does not illuminate in green even if the shift position is in the P range.

- 3) Get into the vehicle while carrying the access key, with the vehicle in P range and the brake pedal ON, check that the engine starts when you press the push button ignition switch.
- 4) With the vehicle stopped, the engine running and in P range, check that the engine stops when you press the push button ignition switch.
- 5) With the vehicle stopped, the engine running and in N range, check that the engine stops when you press the push button ignition switch, and cycles through ACC → IGN ON each time you press the push button ignition switch.

• MT model

- 1) Get into the vehicle while carrying the access key, with the clutch pedal OFF, and check that every time the push button ignition switch is pressed, that it cycles through ACC → IGN ON → IGN OFF, and the indicator light for the push button ignition switch is illuminated in orange.
- 2) Get into the vehicle while carrying the access key, with the clutch pedal ON, check that the indicator light for the push button ignition switch is illuminated in green.
- 3) Get into the vehicle while carrying the access key, with the clutch pedal ON, check that the engine starts when you press the push button ignition switch.
- 4) With the vehicle stopped and the engine running, check that the engine stops when you press the push button ignition switch.

32.STARTING CONDITION

Start the engine and check that the engine starts smoothly. If the battery voltage is low, recharge or replace the battery. If any noises are observed, immediately stop the engine and check and repair the abnormal components.

33.EXHAUST SYSTEM

Listen to the exhaust noise to see if no exhaust gas leak or abnormal noises are observed.

34.INDICATOR LIGHT AND WARNING LIGHT

Check that all indicator lights and warning lights operate normally.

35.HEATER & VENTILATION

Operate the heater & ventilation system to check for normal airflow outlet control, air inlet control, airflow capacity and heating performance.

36.AIR CONDITIONER

Operate the air conditioner. Check that the A/C compressor operates normally and enough cooling is provided.

NOTE:

To prevent the insufficient lubrication of the air conditioner, operate the air conditioner for five minutes at idling.

37.MULTI-FUNCTION DISPLAY (MFD)

- 1) Check that the Multi-Function Display (MFD) function operates normally. (Refer to the owner's manual for the operation procedures.)
- 2) Check that the rearview camera operates normally.

38.AUDIO

Check that all radio functions operate, the speakers emit sound properly and the noise is at an acceptable level. Also check the CD unit and AUX unit operations.

39.NAVIGATION SYSTEM

- 1) Check all display functions for normal operation. (Refer to the owner's manual for the operation procedures.)
- 2) Check that the navigation system operates normally.
- 3) Check that the rearview camera operates normally.

40.ACCESSORY POWER SUPPLY SOCKET

- 1) Check the operation of the front accessory power supply socket.
- 2) Check operation of the accessory power supply socket in console box.

41.LIGHTING SYSTEM

- 1) Check the headlight operations.
- 2) Check the stop light operation.
- 3) Check other lights for normal operations.
- 4) Check the manual levelers of the halogen headlight for normal operations.

42.WIPER DEICER

Check that the wiper deicer operates normally.

NOTE:

When an ambient temperature is 5°C or more, wiper deicer operation is cancelled. Press the switch for 3 seconds or more to perform the compulsory operation.

43.ILLUMINATION CONTROL

Check that the illumination control operates normally.

44.WINDOW WASHER

Check that the window washer injects the washer fluid to the specified area of the windshield. <Ref. to WW-27, ADJUSTMENT, Front Washer Nozzle.>

45.WIPER

Check that the front wiper operates normally.

46.POWER WINDOW

- Operate the power window switches one by one to check that each of the power windows goes up and down without noises.
- Check AUTO UP/AUTO DOWN operate properly by operating the power window switch on driver's seat side.

CAUTION:

If battery has been removed, AUTO UP does not operate properly because initialized. In this case, perform the initial setting (reset A) and check AUTO UP operates properly.

NOTE:

Check the power window if the door glass of the driver's seat does not open/close automatically. <Ref. to GW-9, INSPECTION, Power Window System.>

47.SUNROOF

Check that the sunroof operates normally.

NOTE:

For details concerning sunroof initialization, refer to the "SR" section. <Ref. to SR-6, INITIALIZE OPERATION, OPERATION, Sunroof Control System.>

48.REAR DEFOGGER

Check that the rear defogger operates normally.

49.DOOR MIRROR

Check that the mirror heater and remote control mirror operate normally.

50.PARKING BRAKE

Check the parking brake for normal operations. When pulling the parking brake lever with a force of 200 N (20 kgf, 45 lb), check that the lever stroke of parking brake lever is 7 to 8 notches.

51.DIAGNOSTIC TROUBLE CODE (DTC) CHECK

Read the diagnostic trouble code and check that the diagnostic trouble code is not detected.

If any diagnostic trouble code is detected, clear all.

1) Read Diagnostic Trouble Code

NOTE:

For detailed operation procedures, refer to "PC application help for Subaru Select Monitor".

2) Clear Memory Mode

NOTE:

For detailed operation procedures, refer to "PC application help for Subaru Select Monitor".

52.BRAKE TEST

Check the foot brake for normal operations.

NOTE:

On the model with brake assist mechanism, the brake pedal feels lighter when the brake pedal is depressed hard or quickly. However, those are not malfunction but the phenomena that occur when the brake assist mechanism functions properly.

53.SHIFT CONTROL**• CVT**

- 1) Turn the ignition switch to ON.
- 2) While brake pedal is not depressed, check if the select lever does not move from “P” range.
- 3) While brake pedal is depressed, check if the select lever moves from “P” range.
- 4) Set the selector lever to each gear position and check the shifting while driving the vehicle. Operate the paddle shift at manual mode and check the shifting while driving the vehicle.

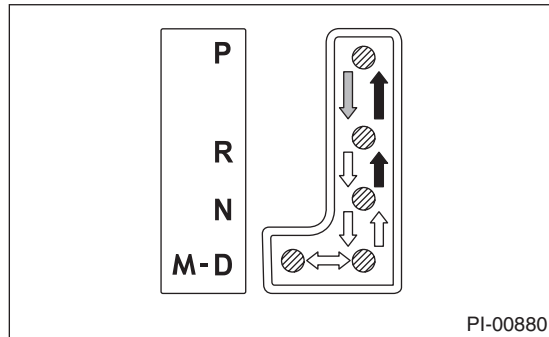

Selector position	Gear position							
	1st	2nd	3rd	4th	5th	6th	7th ^{*1}	8th ^{*1}
D	Continuously variable speed change							
Manual mode	OK	OK	OK	OK	OK	OK	OK	OK

^{*1}: In S# mode

- 5) Set the select lever to other than “P” range. (Except for models with keyless access function)
- 6) When the ignition switch is turned to OFF, check if the ignition key switch cannot be removed. (Except for models with keyless access function)

Pre-delivery Inspection

PRE-DELIVERY INSPECTION

• 6MT (Except for STI model)

- 1) Check for smooth operation to each position. Especially, shift to 5th \longleftrightarrow 6th and to Rev, and check for stuck.
- 2) Check the slider returns to the original position by shifting to the Rev and then back in neutral while pulling up the slider.
- 3) If the shifting operation is not smooth, readjust the exposed length (a) of MT gear select cable by referring to the following figure.

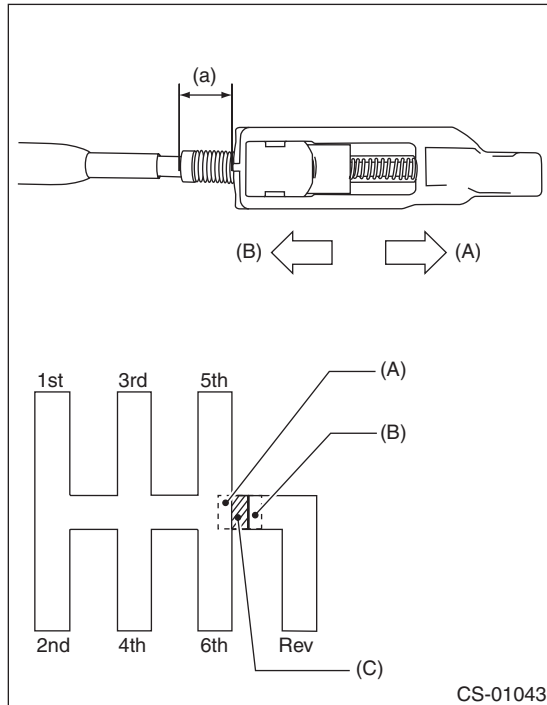

- (a) Exposed length of MT gear select cable
- (A) Extend direction of exposed length of MT gear select cable
- (B) Shorten direction of exposed length of MT gear select cable
- (C) Specification of exposed length (a)

- If the shift cannot be inserted to push the reverse lock bracket 5th and 6th.
→ Extend the exposed length (a) of MT gear select cable.
- When operate the select lever to 4th \rightarrow 5th, it cannot be operated at select lever crank line.
→ Shorten the exposed length (a) of MT gear select cable.

• 6MT (STI model)

- 1) Check for smooth operation to each position.
- 2) Check that the lever cannot be moved to the reverse position unless the slider is pulled up.
- 3) Check that the lever can be moved to the reverse position when the slider is pulled up.

54. CRUISE CONTROL

Operate the cruise control system. Check that the system is activated and deactivated correctly.

55. POWER STEERING FLUID LEVEL (HYDRAULIC POWER STEERING MODEL)**CAUTION:**

If any power steering fluid is spilt over the exhaust pipe, wipe it off with a cloth to avoid emitting smoke or causing a fire.

Check that the power steering fluid level is normal. If the amount of power steering fluid is insufficient, check that no leaks are found. Then add the necessary amount of the specified power steering fluid.

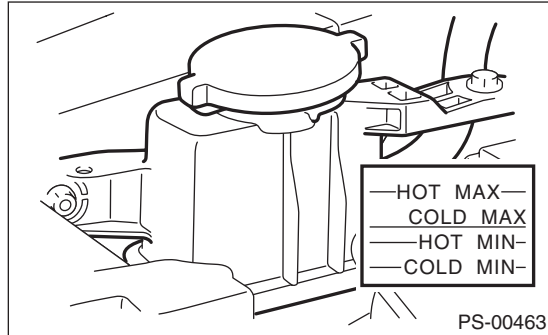
**56. POWER STEERING SYSTEM (ELECTRIC POWER STEERING MODEL)**

Check that the electric power steering warning light illuminates when the ignition switch is turned to ON, and that the electric power steering warning light goes off after the engine is started.

57. FLUID LEAKAGE

Check entire areas of the vehicle for any trace of coolant/oil (such as engine and gear oil)/fluid (such as transmission and brake) leaks.

58. WATER LEAK TEST

Spray the vehicle with water using a hose and check that no water enters the passenger compartment.

- Before performing the water leakage test, remove anything that may obstruct the operation or which must be kept dry.
- Close all the windows and doors securely. Close the front hood and trunk lid before starting the test.
- Spray the vehicle with water using a hose. The rate of water spray must be approx. 20 to 25 L (5.3 — 6.6 US gal, 4.4 — 5.5 Imp gal) per minute.

When spraying water on areas adjacent to the floor and wheel house, increase the pressure. When spraying water on areas other than the floor and wheel house, decrease the pressure. But the force of water must be made strong occasionally by pressing the end of the hose.

NOTE:

Be sure to keep the hose at least 10 cm (3.9 in) away from vehicle.

Check the following areas.

- Front window and body framework mating portion
- Door mating portions
- Glass mating portions
- Rear quarter window mating portions
- Rear window and body framework mating portion
- Around roof drips

If any dampness in the compartments is discovered after the water has been applied, carefully check all the areas that may have possibly contributed to the leak.

Pre-delivery Inspection

PRE-DELIVERY INSPECTION

59.APPEARANCE 2

1) If protective coating (wrap guard) is applied, remove it.

NOTE:

- It is easier to remove the wrap guard using steam.
- For a vehicle left for a long time or at low temperature, sprinkle some water heated to 50 — 60°C (122 — 140°F) over the vehicle to raise its surface temperature before peeling off the wrap guard. Do not use the water heated to over 60°C (140°F).
- If the adhesive remains exist on the coated surface, soak a flannel rag, etc. with a small amount of coating wax or solvent such as oil benzene and IPA, put the soaked cloth on the remains lightly, and then wipe them off with a flannel rag etc.
- Keep solvent from touching the resin or rubber parts. Do not use coating wax or solvent while the component surface temperature is high due to hot weather etc.
- If the coated surface is swollen out due to seams or moisture, expose the vehicle to the sunlight for a few hours or heat the seam and swollen portions using a dryer etc.
- Dispose of the peeled wrap guard as burnable industrial garbage.
- If any label is attached to the fog light lens, remove it.

2) Check the whole vehicle body for flaking paint, damage by transportation, corrosion, dirt, cracks or blisters.

NOTE:

- It is better to determine an inspection pattern in order to avoid missing an area, since the total inspection area is wide.
- Do not repair the body paint unless absolutely necessary. Also, if the vehicle is in need of repair to remove scratches or corroded paint, the repair area must be limited to the minimum. Re-painting and spray painting must be avoided as much as possible.

3) Check each window glass for scratches carefully. Slight damage may be removed by polishing with cerium oxide. (Fill a cup half with cerium oxide, and add warm water to it. Then agitate the content until it turns to wax. Apply this wax to a soft cloth, and polish the glass with it.)

4) Check each portion of the vehicle body and underside components for the formation of rust. If rust is discovered, remove it with sandpaper of #80 to #180 and treat the surface with rust preventive. After this treatment is completed, flush the portion thoroughly, and prepare the surface for repair painting.

5) Check each portion of body and all of the exterior parts for deformation or distortion. Also, check each light lens for cracks.

6) Peel the protective tape, vinyl wrapping and identification seal attached to the following places.

- Seat
- Door trim
- Floor carpet
- Side sill (with SUS plate RH/LH)
- Front hood lock release lever
- Fuel opener lever
- Door mirror
- Front fog light
- Rear shelf
- Aluminum pedal

PERIODIC MAINTENANCE SERVICES

PM

	Page
1. General Description	2
2. Schedule	3
3. Engine Oil	6
4. Engine Oil Filter	7
5. Spark Plug	8
6. V-belt	9
7. Timing Belt	10
8. Fuel Line	11
9. Fuel Filter	12
10. Air Cleaner Element	13
11. Cooling System	14
12. Engine Coolant	15
13. Clutch System	16
14. Transmission Gear Oil	17
15. CVTF	18
16. Front & Rear Differential Gear Oil	19
17. Brake Line	20
18. Brake Fluid	22
19. Disc Brake Pad and Disc	23
20. Parking Brake	24
21. Suspension	25
22. Wheel Bearing	29
23. Axle Boots & Joints	30
24. Tire Inspection and Rotation	31
25. Steering System (Power Steering)	32
26. A/C Filter	37